

2006-0765

INTEGRUS  
ARCHITECTURE

7978  
REGISTERED ARCHITECT  
*[Signature]*  
BRIAN FORD CARTER  
STATE OF WASHINGTON

Zone	P-6-8	Corner	Flag
Setbacks	Required	Actual	
Front	25'	41'	
Sides	all sides	7'1	
Rear	5'1	52'8	
Other	15	8'60	
Height	15	10.25	

EMERGENCY STORAGE STRUCTURES

FORMER WOODWAY HIGH SCHOOL  
23200 100TH AVE W  
EDMONDS, WASHINGTON 98020

APPROVED BY PLANNING  
grom 07/27/06

APPROVED BY ENGINEERING  
*[Signature]*

VICINITY MAP, SITE PLAN  
Date: 7/15/06

RESUB

A0.1 JUL 18 2006

BUILDING DEPARTMENT  
CITY OF EDMONDS

PERMIT SET

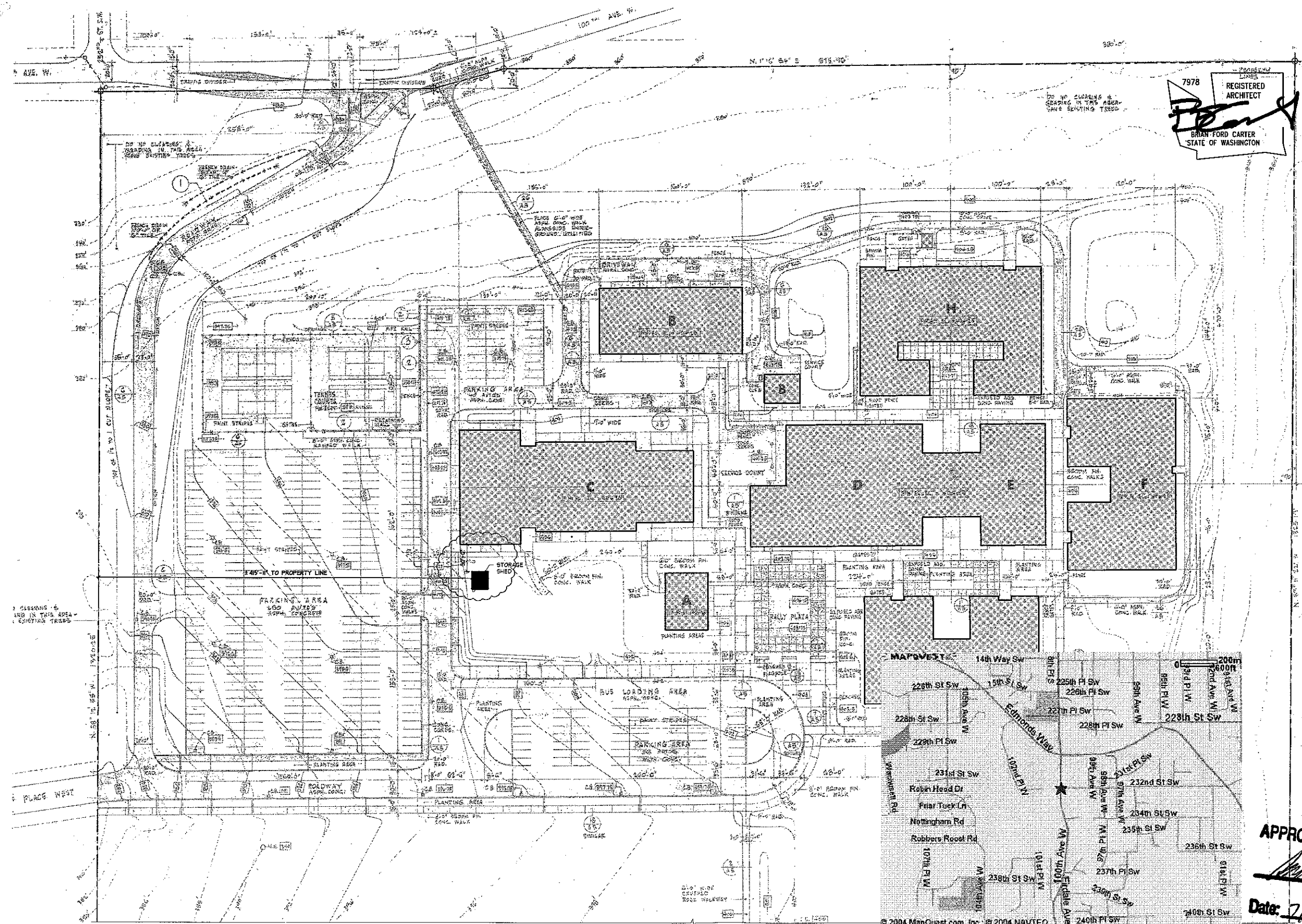

1 FORMER WOODWAY HIGH SCHOOL SITE PLAN  
1" = 40'-0"

NOTES:  
CONSTRUCTION TYPE - V-B  
SEE 1/A/1 & 4/A/1 FOR FLOOR PLAN

APPROVED  
FIRE DEPARTMENT  
7/23/06  
*[Signature]*

APPROVED BY PLANNING  
grom 07/27/06

2 VICINITY MAP  
N.T.S.

CITY COPY