

CITY OF EDMONDS CONSTRUCTION PERMIT APPLICATION				PERMIT EXPIRES <u>11/7/99</u>	
<b>OWNER NAME/NAME OF BUSINESS</b> <u>Brian Bright Angies Little Italy</u> <b>MAILING ADDRESS</b> <u>23025 100th Ave NE</u> <b>CITY</b> <u>Edmonds WA</u> <b>STATE</b> <u>WA</u> <b>ZIP</b> <u>98020</u> <b>TELEPHONE</b> <u>425-776-1444</u>				<b>PERMIT NUMBER</b> <u>990258</u>	
				<b>JOB ADDRESS</b> <u>23025 100th Ave NE</u>	
<b>LEGAL DESCRIPTION CHECK</b>				<b>SUBDIVISION NO.</b>	
<b>PUBLIC RIGHT OF WAY PER OFFICIAL STREET MAP</b> EXISTING _____ REQUIRED DEDICATION _____ PROPOSED _____				<b>TESCP Approved</b> <input type="checkbox"/> <b>RV Permit Required</b> <input type="checkbox"/> <b>Street Use Permit Req'd</b> <input type="checkbox"/> <b>Inspection Required</b> <input type="checkbox"/> <b>Sidewalk Required</b> <input type="checkbox"/>	
<b>METER SIZE</b>		<b>LINE SIZE</b>		<b>NO. OF FIXTURES</b>	
<b>REMARKS</b>				<b>PRV REQUIRED</b> YES <input type="checkbox"/> NO <input type="checkbox"/>	
<b>ENGINEERING MEMO DATED</b>				<b>REVIEWED BY</b>	
<b>FIRE MEMO DATED</b>				<b>REVIEWED BY</b>	
<b>VARIANCE OR CU</b> <u>N/A</u> <b>ADB#</b> <u>99-82 100th</u> <b>ENCLOSURE #</b> <u>N/A</u>				<b>SEPA REVIEW</b> <input checked="" type="checkbox"/> <b>COMPLETE</b> <input checked="" type="checkbox"/> <b>EXEMPT</b> <input type="checkbox"/>	
<b>LOT COVERAGE</b> <u>N/A</u> <b>REQUIRED SETBACKS (FT.)</b> <u>N/A</u> <b>PROPOSED SETBACKS (FT.)</b> <u>N/A</u>				<b>HEIGHT</b> <u>14'</u> <b>PROPOSED</b> <u>14'</u>	
<b>REMARKS</b> <u>approved for pole sign structure only! Additional sign application to come later.</u>				<b>DATE</b> <u>5/7/99</u>	
<b>CHECKED BY</b> <u>Sign</u> <b>TYPE OF CONSTRUCTION</b> <u>Sign</u> <b>CODE</b> <u>77</u> <b>OCCUPANT GROUP</b> <u>A3</u>				<b>SPECIAL INSPECTOR REQUIRED</b> <input type="checkbox"/> <b>YES</b>	
<b>REMARKS</b> <b>PROGRESS INSPECTIONS PER UBC 108</b>				<b>OCCUPANT LOAD</b>	
<b>FINAL INSPECTION REQUIRED</b>					
<b>PLAN CHECK FEE</b>		<b>VALUATION</b>		<b>FEE</b>	
<b>BUILDING</b> <u>4x6</u>		<u>Sign</u>		<u>108.00</u>	
<b>PLUMBING</b>					
<b>MECHANICAL</b>					
<b>GRADING/FILL</b>					
<b>STATE SURCHARGE</b>					
<b>STORM DRAINAGE FFFS</b>					
<b>ENG. INSPECTION FEE</b>					
<b>PLAN CHECK DEPOSIT</b>					
<b>TOTAL AMOUNT DUE</b>		<u>108.00</u>		<u>132.46</u>	
<b>CALL FOR INSPECTION</b> (425) 771-0220		<b>APPLICATION APPROVAL</b> This application is not a permit until signed by the Building Official or his/her Deputy, and Fees are paid, and receipt is acknowledged in space provided.			
<b>SIGNATURE (OWNER OR AGENT)</b> <u>[Signature]</u> <b>DATE SIGNED</b> <u>5-6-99</u>		<b>OFFICIALS SIGNATURE</b> <u>[Signature]</u> <b>DATE</b> <u>5/7/99</u>			
		<b>RELEASED BY</b> <u>[Signature]</u> <b>DATE</b> <u>5/7/99</u>			

NOTICE: IF THE DOCUMENT IN THIS FRAME IS LESS CLEAR THAN THIS NOTICE IT IS DUE TO THE QUALITY OF THE DOCUMENT.

**ATTENTION**  
 IT IS UNLAWFUL TO USE OR OCCUPY A BUILDING OR STRUCTURE UNTIL A FINAL INSPECTION HAS BEEN MADE AND APPROVAL OR A CERTIFICATE OF OCCUPANCY HAS BEEN GRANTED. UBC SECTION 109

# Plot Plan ANGIES LITTLE ITALY

← NORTH

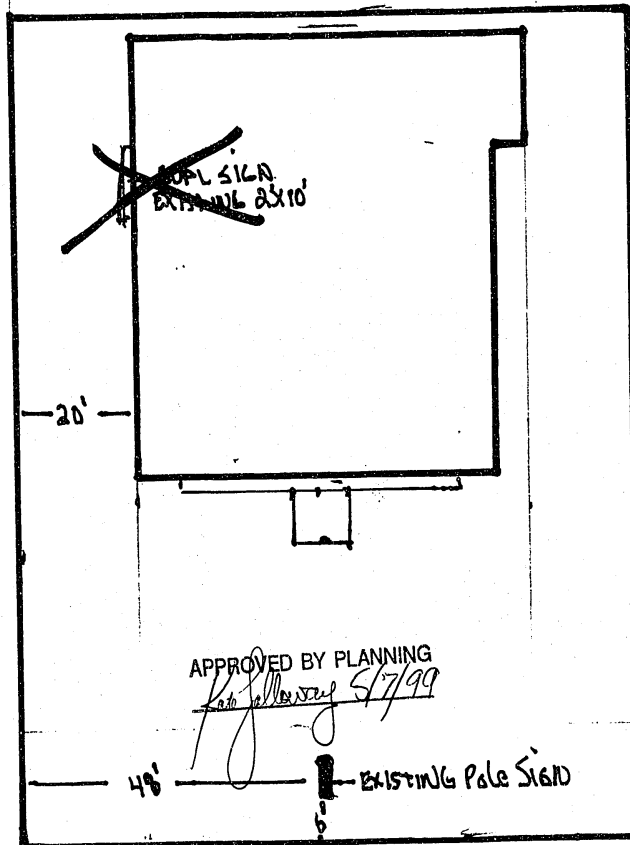

RECEIVED

MAY 06 1999

PERMIT COUNTER

APPROVED BY PLANNING

*[Signature]* 5/7/99

48'

EXISTING Pole Sign

95'

100th Street

JIM MANNING AND ASSOCIATES  
131 - 2nd Avenue South  
Edmonds, WA 98020

EXISTING SIGN IS 48' FROM NORTH PROPERTY LINE,  
20' TO 1" SCALE 6' BACK FROM WEST PROPERTY LINE

NOTICE: IF THE DOCUMENT IN THIS FRAME IS LESS CLEAR THAN THIS NOTICE  
IT IS DUE TO THE QUALITY OF THE DOCUMENT.

324080

# RECORD OF INSPECTIONS

	INSPECTOR	DATE APPROVED
SETBACKS .....		
FOUNDATION:		
Footing .....		
Wall .....		
Pier/Porch .....		
Retaining Wall .....		
Slab Insulation .....		
PLUMBING:		
Underground .....		
Rough-In .....		
Commercial Final .....		
HEATING:		
Gas Test .....		
Gas Piping .....		
Equipment .....		
Commercial Final .....		
EXTERIOR SHEATHING		
NAILING .....		
FRAMING .....		
INSULATION .....		
Floor Insulation .....		
Wall Insulation .....		
Ceiling Insulation .....		
SHEETROCK NAILING ...		
SPECIAL INSPECTION ...		
MISCELLANEOUS .....		
FINAL APPROVAL FOR		
OCCUPANCY .....	<u>TES</u>	<u>8-16-99</u>

NOTICE: IF THE DOCUMENT IN THIS FRAME IS LESS CLEAR THAN THIS NOTICE IT IS DUE TO THE QUALITY OF THE DOCUMENT.

✓990258

CITY OF EDMONDS CONSTRUCTION PERMIT APPLICATION				PERMIT EXPIRES 11/7/99	
<b>OWNER</b> OWNER NAME/NAME OF BUSINESS: <u>Brian Bright Angies Little Italy</u> MAILING ADDRESS: <u>23025 100th Ave NE</u> CITY: <u>Edmonds WA 98020</u> ZIP: <u>98020</u> TELEPHONE: <u>425-776-1444</u>				USE ZONE: _____ PERMIT NUMBER: <b>990258</b>	
				JOB ADDRESS: <u>23025 100th Ave NE</u> SUITE/APT# _____	
<b>ARCHITECT</b> NAME: _____ ADDRESS: _____ CITY: _____ ZIP: _____ TELEPHONE: _____				LEGAL DESCRIPTION CHECK: _____ SUBDIVISION NO. _____ LID NO. _____	
				PUBLIC RIGHT OF WAY PER OFFICIAL STREET MAP EXISTING _____ REQUIRED DEDICATION _____	
<b>CONTRACTOR</b> NAME: <u>Jim Manning Assoc.</u> ADDRESS: <u>131 2nd Ave</u> CITY: <u>Edmonds 98020</u> ZIP: _____ TELEPHONE: <u>327-1078</u> STATE LICENSE NUMBER: <u>JIMMAA*208 M S 11/15/99</u> EXPIRATION DATE: _____ CHECKED BY: <u>OKR</u>				TESP Approved <input type="checkbox"/> RW Permit Required <input type="checkbox"/> Street Use Permit Req'd <input type="checkbox"/> Inspection Required <input type="checkbox"/> Sidewalk Required <input type="checkbox"/>	
				METER SIZE _____ LINE SIZE _____ NO. OF FIXTURES _____ YES <input type="checkbox"/> NO <input type="checkbox"/>	
<b>LEGAL DESCRIPTION</b> LEGAL DESCRIPTION OF PROPERTY - INCLUDE ALL EASEMENTS: _____ PROPERTY TAX ACCOUNT PARCEL NO.: <u>3677 031 137 00</u>				<b>REMARKS</b> <div style="text-align: center; font-size: 2em; font-weight: bold;">COMPLETED</div>	
<b>JOB DESCRIPTION</b> <input type="checkbox"/> NEW <input type="checkbox"/> RESIDENTIAL <input type="checkbox"/> PLUMBING / MECH <input type="checkbox"/> ADDITION <input checked="" type="checkbox"/> COMMERCIAL <input type="checkbox"/> COMPLIANCE OR CHANGE OF USE <input checked="" type="checkbox"/> REMODEL <input type="checkbox"/> APARTMENT <input checked="" type="checkbox"/> SIGN <input type="checkbox"/> REPAIR <input type="checkbox"/> GRADING CYDS _____ <input type="checkbox"/> FENCE ( _____ X _____ FT) <input type="checkbox"/> DEMOLISH <input type="checkbox"/> TANK <input type="checkbox"/> OTHER _____ <input type="checkbox"/> GARAGE CARPORT <input type="checkbox"/> RETAINING WALL ROCKERY <input type="checkbox"/> RENEWAL				VARIANCE/CR CU _____ ADB# _____ SHORELINE # _____ SEPA REVIEW _____ SIGN AREA _____ COMPLETE _____ ALLOWED PROPOSED _____ EXP _____ 60' 24' 14' 14'	
				(TYPE OF USE, BUSINESS OR ACTIVITY) EXPLAIN: <u>Restaurant</u> NUMBER OF STORIES: <u>1</u> NUMBER OF DWELLING UNITS: <u>0</u> CRITICAL AREAS NUMBER: <u>NA</u> DESCRIBE WORK TO BE DONE: <u>Install New Faces in existing Sign Cabinet (bleed)</u> <u>4 x 6</u>	
CHECKED BY: _____ TYPE OF CONSTRUCTION: _____ CODE: <u>97</u> OCCUPANT GROUP: <u>A3</u> SPECIAL INSPECTOR REQUIRED <input type="checkbox"/> YES <input checked="" type="checkbox"/> NO					
<b>PERMIT LIMIT</b> THIS PERMIT AUTHORIZES ONLY THE WORK NOTED. THIS PERMIT COVERS WORK TO BE DONE ON PRIVATE PROPERTY ONLY. ANY CONSTRUCTION ON THE PUBLIC DOMAIN (CURBS, SIDEWALKS, DRIVEWAYS, MARQUEES, ETC.) WILL REQUIRE SEPARATE PERMISSION. PERMIT APPLICATION: 180 DAYS PERMIT LIMIT: 1 YEAR - PROVIDED WORK IS STARTED WITHIN 180 DAYS				<b>REMARKS</b> <u>PROGRESS INSPECTIONS PER UBC 108</u>	
				<b>FINAL INSPECTION REQUIRED</b>	
<b>HOLD HARMLESS</b> I HEREBY ACKNOWLEDGE THAT I HAVE READ THIS APPLICATION, THAT THE INFORMATION GIVEN IS CORRECT, AND THAT I AM THE OWNER, OR THE DULY AUTHORIZED AGENT OF THE OWNER, I AGREE TO COMPLY WITH CITY AND STATE LAWS REGULATING CONSTRUCTION, AND IN DOING THE WORK AUTHORIZED THEREBY, NO PERSON WILL BE EMPLOYED IN VIOLATION OF THE LABOR CODE OF THE STATE OF WASHINGTON RELATING TO WORKMEN'S COMPENSATION INSURANCE AND RCW 49.57.				VALUATION: _____ FEE: _____	
				PLAN CHECK DEPOSIT: _____ TOTAL AMOUNT DUE: <u>108.00</u> <u>132.46</u>	
<b>ATTENTION</b> IT IS UNLAWFUL TO USE OR OCCUPY A BUILDING OR STRUCTURE UNTIL A FINAL INSPECTION HAS BEEN MADE AND APPROVAL OR A CERTIFICATE OF OCCUPANCY HAS BEEN GRANTED. UBC SECTION 109				<b>APPLICATION APPROVAL</b> This application is not a permit until signed by the Building Official or his/her Deputy, and Fees are paid, and receipt is acknowledged in space provided.	
				CALL FOR INSPECTION (425) 771-0220 OFFICIAL'S SIGNATURE: <u>[Signature]</u> DATE: <u>5/7/99</u> RELEASED BY: <u>[Signature]</u> DATE: <u>5/7/99</u>	

NOTICE: IF THE DOCUMENT IN THIS FRAME IS LESS CLEAR THAN THIS NOTICE IT IS DUE TO THE QUALITY OF THE DOCUMENT.

ORIGINAL - FILE • YELLOW - INSPECTOR  
PINK - OWNER • GOLD - ASSESSOR

sent  
kg  
8/13